

\$119,500 - 834, 11013 Hwy 28, Rural St. Paul County

MLS® #E4439813

\$119,500

1 Bedroom, 0.00 Bathroom, 466 sqft

Rural on 0.50 Acres

Upper Mann Lake, Rural St. Paul County, AB

Half an acre private, treed lot at Upper Mann Lake in the County of St. Paul. Three season, one bedroom cottage with wood burning stove, charming kitchen and living room area. Two water tanks outside are connected to inside the house at the kitchen sink. This property has two additional lots next door which are also for sale. Absolutely adorable fifth wheel included in the sale, great for guests. Enjoy the summers at the lake, take a drive minutes away to all of the lakes close by and relax away from the city. Located on Kaehn Drive, just off highway 28, a great community for families. Your home away from home awaits.

Built in 1998

Essential Information

MLS® #	E4439813
Price	\$119,500
Bedrooms	1
Bathrooms	0.00
Square Footage	466
Acres	0.50
Year Built	1998
Type	Rural
Sub-Type	Detached Single Family
Style	Bungalow
Status	Active

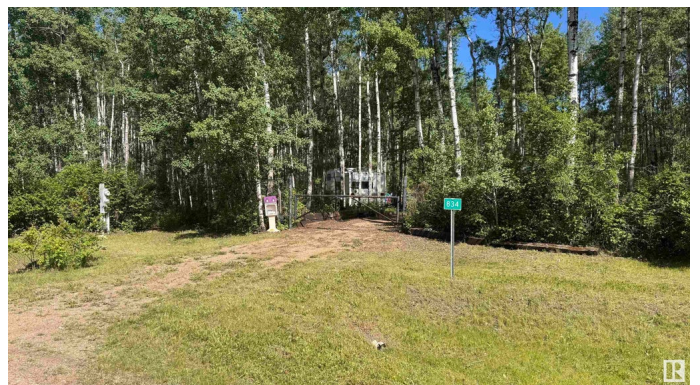
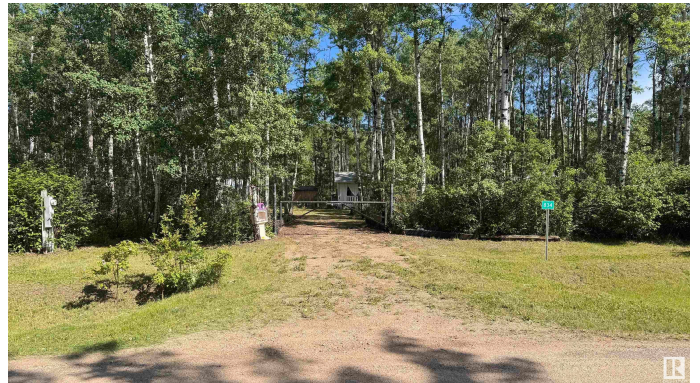

Community Information

Address	834, 11013 Hwy 28
Area	Rural St. Paul County
Subdivision	Upper Mann Lake
City	Rural St. Paul County
County	ALBERTA
Province	AB
Postal Code	T0A 0C0

Amenities

Features	Front Porch, No Smoking Home, R.V. Storage
----------	--

Interior

Heating	Wood Stove, Wood
Stories	1
Has Basement	Yes
Basement	None, No Basement

Exterior

Exterior	Wood
Exterior Features	Not Fenced, Treed Lot
Construction	Wood
Foundation	Preserved Wood

Additional Information

Date Listed	June 1st, 2025
Days on Market	65
Zoning	Zone 60

DATA IS DEEMED RELIABLE BUT IS NOT GUARANTEED ACCURATE BY THE REALTORS® ASSOCIATION OF EDMONTON. COPYRIGHT 2025 BY THE REALTORS® ASSOCIATION OF EDMONTON. ALL RIGHTS RESERVED. Trademarks are owned or controlled by the Canadian Real Estate Association (CREA) and identify real estate professionals who are members of CREA (REALTOR®, REALTORS®) and/or the quality of services they provide (MLS®, Multiple Listing Service®)

Listing information last updated on August 5th, 2025 at 10:02am MDT