

## \$89,900 - 580 Rr240, Rural Sturgeon County

MLS® #E4293849

**\$89,900**

0 Bedroom, 0.00 Bathroom,  
Rural on 2.47 Acres

None, Rural Sturgeon County, AB

Great opportunity for development in Sturgeon County. This well situated acreage with great views and gently rolling topography is located short driving distance from pavement (hwy 651, Lily lake road) and towns of Legal, Gibbons, Morinville, CFB Edmonton and Edmonton. Many notable features of the property that create added value include power on the property, Drilled well and an approach with culvert. Don't miss out on this incredible acreage!

### Essential Information

MLS® #	E4293849
Price	\$89,900
Bathrooms	0.00
Acres	2.47
Type	Rural

### Community Information

Address	580 Rr240
Area	Rural Sturgeon County
Subdivision	None
City	Rural Sturgeon County
County	ALBERTA
Province	AB
Postal Code	T0G 1L2

### Exterior

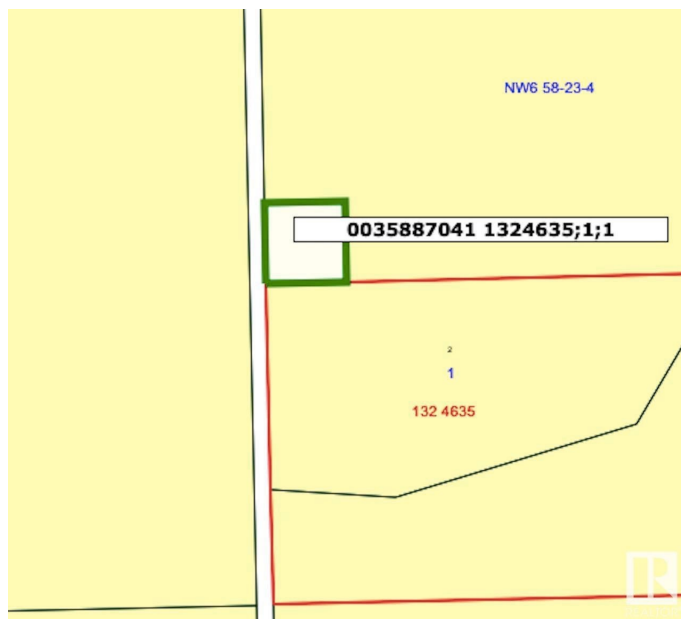

Exterior Features    Rolling Land, See Remarks

**Additional Information**

Date Listed                May 13th, 2022

DATA IS DEEMED RELIABLE BUT IS NOT GUARANTEED ACCURATE BY THE REALTORS® ASSOCIATION OF EDMONTON. COPYRIGHT 2024 BY THE REALTORS® ASSOCIATION OF EDMONTON. ALL RIGHTS RESERVED.Trademarks are owned or controlled by the Canadian Real Estate Association (CREA) and identify real estate professionals who are members of CREA (REALTOR®, REALTORS®) and/or the quality of services they provide (MLS®, Multiple Listing Service®)  
Listing information last updated on May 19th, 2024 at 12:31pm MDT